



Synchronous Tapping Attachments

SYNCHRONOUS ER TAPPING ATTACHMENT with QUICK-CHANGE TAP ADAPTOR
With internal through coolant capability (*)



DIN 69893 HSK A

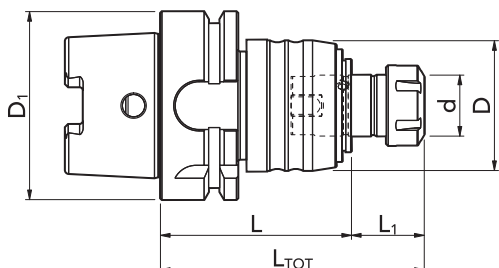

Article Code	Attachment øD _i [mm]	Tap Size	L [mm]	ø D [mm]	ø d [mm]	ER collet	L ₁ [mm]	L _{TOT} [mm]
VA01A06302CH160	HSK-A63	M3 - M8	64	43	20	ER 16	20,5	84,5
VA01A06302CH250	HSK-A63	M6 - M20	97	60	32	ER 25	23,5	120,5
VA01A10002CH400	HSK-A100	M14 - M33	115	87	50	ER 40	28,5	143,5

SYNCHRONOUS ER TAPPING ATTACHMENT with QUICK-CHANGE TAP ADAPTOR
With internal through coolant capability (*)



DIN 1835 B+E

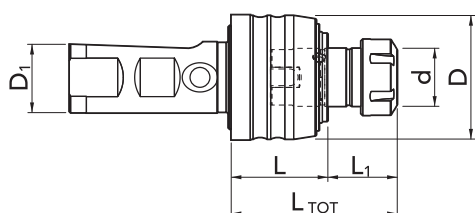

Article Code	Attachment øD _i [mm]	Tap Size	L [mm]	ø D [mm]	ø d [mm]	ER collet	L ₁ [mm]	L _{TOT} [mm]
VA01C02502CH160	25	M3 - M8	34	43	20	ER 16	20,5	54,5
VA01C02502CH250	25	M6 - M20	56	60	32	ER 25	23,5	79,5
VA01C04002CH400	40	M14 - M33	80	87	50	ER 40	28,5	108,5

(*) For coolant pressure above 50 bars a special nut screw is available on request

SYNCHRONOUS ER TAPPING ATTACHMENT with QUICK-CHANGE TAP ADAPTOR
With internal through coolant capability (!)



SK DIN 69871 AD

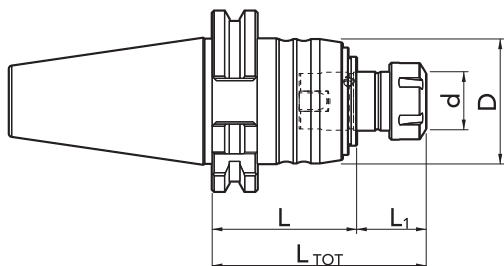

Article Code	Attachment	Tap Size	L [mm]	ø D [mm]	ø d [mm]	ER collet	L ₁ [mm]	L _{TOT} [mm]
VA01B04002CH160	SK 40 AD	M3 - M8	53	43	20	ER 16	20,5	73,5
VA01B05002CH160	SK 50 AD	M3 - M8	53	43	20	ER 16	20,5	73,5
VA01B04002CH250	SK 40 AD	M6 - M20	90	60	32	ER 25	23,5	113,5
VA01B05002CH250	SK 50 AD	M6 - M20	74	60	32	ER 25	23,5	97,5

SYNCHRONOUS ER TAPPING ATTACHMENT with QUICK-CHANGE TAP ADAPTOR
With internal through coolant capability (!)



SK DIN 69871 AD+B

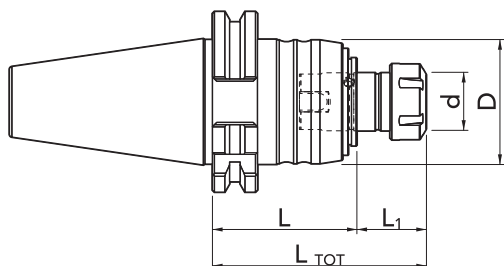

Article Code	Attachment	Tap Size	L [mm]	ø D [mm]	ø d [mm]	ER collet	L ₁ [mm]	L _{TOT} [mm]
VA01B05002CH400	SK 50 B	M14 - M33	115	87	50	ER 40	28,5	143,5

VA SERIES

(!) For coolant pressure above 50 bars a special nut screw is available on request

SYNCHRONOUS ER TAPPING ATTACHMENT with QUICK-CHANGE TAP ADAPTOR
With internal through coolant capability (!)



MAS 403 BT

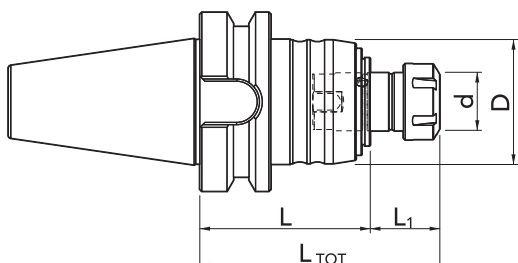

Article Code	Attachment	Tap Size	L [mm]	ø D [mm]	ø d [mm]	ER collet	L ₁ [mm]	L _{TOT} [mm]
VA01M04002CH160	BT 40	M3 - M8	61	43	20	ER 16	20,5	81,5
VA01M05002CH160	BT 50	M3 - M8	72	43	20	ER 16	20,5	92,5
VA01M04002CH250	BT 40	M6 - M20	82	60	32	ER 25	23,5	105,5
VA01M05002CH250	BT 50	M6 - M20	93	60	32	ER 25	23,5	116,5

SYNCHRONOUS ER TAPPING ATTACHMENT with QUICK-CHANGE TAP ADAPTOR
With internal through coolant capability (!)



MAS 403 BT - B

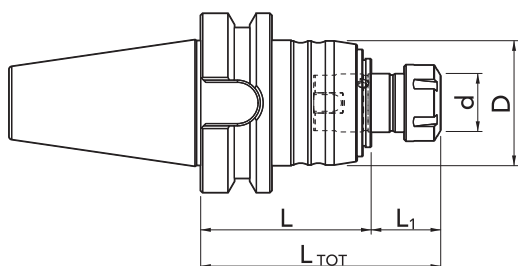

Article Code	Attachment	Tap Size	L [mm]	ø D [mm]	ø d [mm]	ER collet	L ₁ [mm]	L _{TOT} [mm]
VA01M05002CH400	BT 50 B	M14 - M33	124	87	50	ER 40	28,5	152,5

(!) For coolant pressure above 50 bars a special nut screw is available on request

SYNCHRONOUS ER TAPPING ATTACHMENT with QUICK-CHANGE TAP ADAPTOR
With internal through coolant capability (*)



POLIGONAL Attachment ISO 26623-1

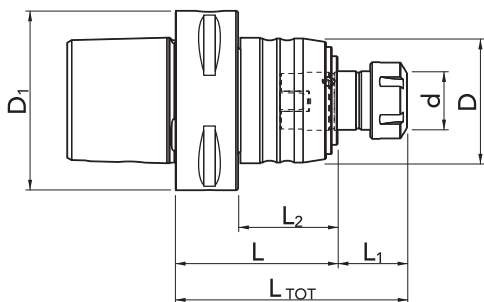

Article Code	Attachment $\varnothing D_1$ [mm]	Tap Size	L [mm]	L_2 [mm]	$\varnothing D$ [mm]	$\varnothing d$ [mm]	ER collet	L_1 [mm]	L_{TOT} [mm]
VA01P04002CH160	C40	M3 - M8	55	35	43	20	ER 16	20,5	75,5
VA01P05002CH160	C50	M3 - M8	55	35	43	20	ER 16	20,5	75,5
VA01P06302CH160	C63	M3 - M8	57	35	43	20	ER 16	20,5	77,5
VA01P08002CH160	C80	M3 - M8	66	36	43	20	ER 16	20,5	86,5
VA01P04002CH250	C40	M6 - M20	75	55	60	32	ER 25	23,5	98,5
VA01P05002CH250	C50	M6 - M20	75	55	60	32	ER 25	23,5	98,5
VA01P06302CH250	C63	M6 - M20	77	55	60	32	ER 25	23,5	100,5
VA01P08002CH250	C80	M6 - M20	86	56	60	32	ER 25	23,5	109,5
VA01P08002CH400	C80	M14 - M33	116	86	87	50	ER 40	28,5	144,5

(*) For coolant pressure above 50 bars a special nut screw is available on request

QUICK-CHANGE TAP ADAPTOR

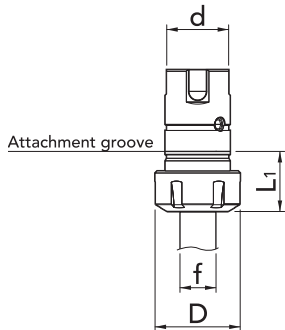

Article Code	Tap Size	Shaft Ø f [mm]	ø d [mm]	ø D [mm]	L ₁	ER collet
*CHADAP160310000	M3 - M8	03 - 08	20	28	20,5	ER 16
CHADAP250316000	M6 - M20	03 - 16	32	42	23,5	ER 25
CHADAP400626000	M14 - M33	06 - 25	50	63	28,5	ER 40

EXTENDED QUICK-CHANGE TAP ADAPTOR

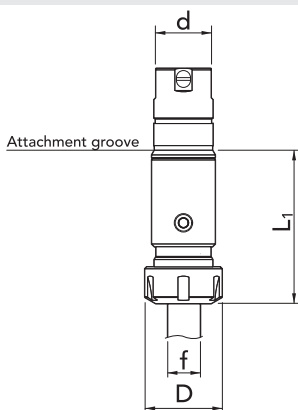

Article Code	Tap Size	Shaft Ø f [mm]	ø d [mm]	ø D [mm]	L ₁	ER collet
*CHEXAD160310000	M3 - M8	03 - 08	20	28	51,5	ER 16
CHEXAD250316000	M6 - M20	03 - 16	32	42	80,5	ER 25
CHEXAD400626000	M14 - M33	06 - 25	50	63	90,5	ER 40

* Hexagonal nut screw

ER COLLET (sealed) - with internal square

DIN 6499

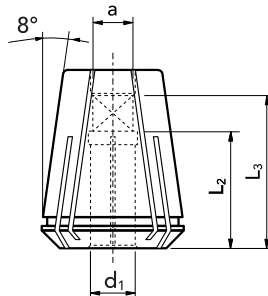

Article Code	ER collet	ø d ₁ [mm]	a [mm]	L ₂ [mm]	L ₃ [mm]
SLERGB160103500	ER 16	3,5	2,7	18	24
SLERGB160104500	ER 16	4,5	3,4	18	24
SLERGB160105500	ER 16	5,5	4,3	18	25
SLERGB160106000	ER 16	6	4,9	18	26
SLERGB160107000	ER 16	7	5,5	18	26
SLERGB160108000	ER 16	8	6,2	22	31
SLERGB250103500	ER 25	3,5	2,7	18	24
SLERGB250104500	ER 25	4,5	3,4	18	24
SLERGB250105500	ER 25	5,5	4,3	18	25
SLERGB250106000	ER 25	6	4,9	18	26
SLERGB250107000	ER 25	7	5,5	18	26
SLERGB250108000	ER 25	8	6,2	22	31
SLERGB250109000	ER 25	9	7	22	32
SLERGB250110000	ER 25	10	8	25	36
SLERGB250111000	ER 25	11	9	25	37
SLERGB250112000	ER 25	12	9	25	37
SLERGB250114000	ER 25	14	11	25	39
SLERGB250116000	ER 25	16	12	25	40
SLERGB400106000	ER 40	6	4,9	18	26
SLERGB400106000	ER 40	7	5,5	18	26
SLERGB400108000	ER 40	8	6,2	22	31
SLERGB400109000	ER 40	9	7	22	32
SLERGB400110000	ER 40	10	8	25	36
SLERGB400111000	ER 40	11	9	25	37
SLERGB400112000	ER 40	12	9	25	37
SLERGB400114000	ER 40	14	11	25	39
SLERGB400116000	ER 40	16	12	25	40
SLERGB400118000	ER 40	18	14,5	25	42
SLERGB400120000	ER 40	20	16	28	47
SLERGB400122000	ER 40	22	18	28	49
SLERGB400125000	ER 40	25	20	33	56

ASSEMBLY SUPPORT

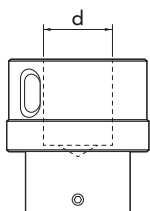

Article Code	ER collet	ø d [mm]
ASCHADAP1620000	ER 16	20
ASCHADAP2532000	ER 25	32
ASCHADAP4050000	ER 40	50

WRENCH for nut screw



Article Code	Nut Screw	ER collet
KE02ER160200000	Esagonale	ER 16
KE04ER250200000	Standard	ER 25
KE04ER400200000	Standard	ER 40